

envirosep MBP

MODULAR BOILER PLANT

Envirosep has led the way in packaged systems by offering designs and manufacturing integrated solutions for fluid handling, heat transfer and energy recovery for over 20 years. We strive to provide the most cost effective and energy efficient engineered modular hot water plants to our customers.

Our engineered modular plant, *envirosep MBP*, is a UL-listed, factory engineered and manufactured mechanical room utilized in conventional building heating systems using hot water as the heating medium. Custom engineering by Envirosep enables the owner to specify key components from a range of manufacturers that meet performance needs. Our knowledgeable engineering staff is available to assist facility owners or engineers in conceptual development and planning.

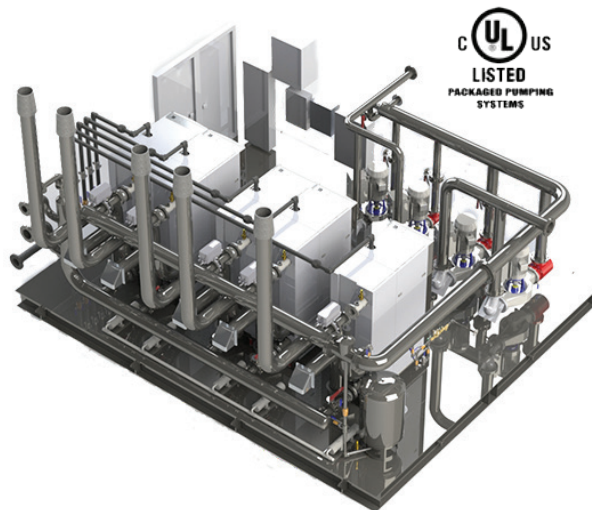

FEATURES & BENEFITS

- Our *envirosep MBP* is factory manufactured, tested and UL-listed ensuring quality and NEC code compliance
- Sole source manufacturing responsibility with just one manufacturer to coordinate
- All components required to integrate a stand-alone boiler plant are included, eliminating site coordination and negating start-up irregularities.
- Our *envirosep MBP* provides a lower cost alternative to site-built central plants while avoiding costly project delays
- The *envirosep MBP* is controlled by a non-proprietary boiler plant optimization controller, providing the best system operating efficiency
- Speeds up installation and start-up which provides significant savings to contractors, engineers and facility owners
- Factory hydrostatic and operational testing performed prior to shipment
- Envirosep provides a dedicated project manager to coordinate all aspects of production, delivery, and site installation assistance

SYSTEM DESIGNS INCLUDE:

- Energy-efficient condensing & non-condensing boilers
- Integrated pumping system-hot water
- Hydronic accessories-air separators & expansion tanks
- Provisions for all gas piping & ventilation
- Variable frequency drives (VFD) & boiler plant controller with touchscreen interface
- Differential pressure, temperature & flow transmitters
- Communication interface to Building Management System (BMS)
- Environmentally-controlled building enclosure with single-point power connection

BOILER PLANT OPTIONS INCLUDE:

- Hybrid systems for low load conditions and dual system operation
- Internet connectivity for remote system monitoring
- Chemical treatment
- System without building enclosure
- Specific performance criteria (upon request)



TECHNICAL DATA

SYSTEM CONDITIONS	RANGE
system heating load (MBH)	as specified
hot water temperature (°F)	70 to 200
number of boilers	as specified
standard power (V)	460 (other available)
operating pressure (psig)	100 to 300
operating temperature (°F)	< 140

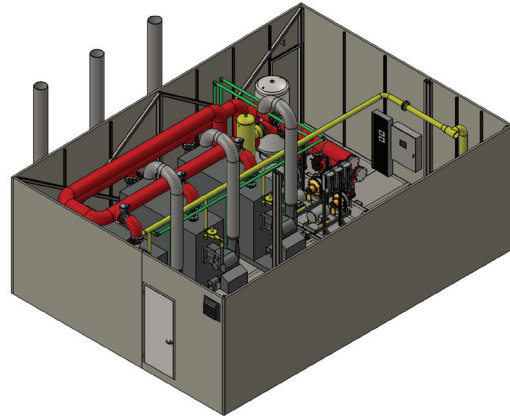

FIGURE 1. Isometric view of a three (3) 3,000 MBH boiler modular plant.



The *envirosep MBP* may be provided as a single, UL listed, package system shipped in one section. Typical one-section boiler plants are available up to 12,000 MBH, depending on system configuration.



For larger boiler plants, multiple sections may be required. Multiple sectioned boiler plants are designed for easy, modular field assembly resulting in minimal installation time and labor. Exhaust stacks are typically shipped loose with the boiler plant for field erection and interconnection to the modular plant. Typical lead time for the *envirosep MBP* is 18-22 weeks depending on approvals.

