

| | | | | | |
|-----------------|-----------------------|------------------|------------------------|-----------|---------|
| PROJECT: | Hydro MPC-CME Booster | UNIT TAG: | | QUANTITY: | 1 |
| REPRESENTATIVE: | Hurley engineering | TYPE OF SERVICE: | Domestic Water Booster | DATE: | 2/10/20 |
| ENGINEER: | TBD | SUBMITTED BY: | Devin Carle | DATE: | |
| CONTRACTOR: | TBD | APPROVED BY: | | DATE: | |
| | | ORDER NO.: | | DATE: | |



Product photo could vary from the actual product

Hydro Multi-E 2 CRE 10-6

Energy efficient pressure boosting system for boosting of clean water. Available with 2-4 parallel connected frequency controlled pumps, integrated advanced controller and all necessary fittings.

| Conditions of Service | Pump Data | Motor Data |
|-------------------------|--|-----------------------|
| Flow: _____ | Maximum operating pressure: 232.06 psi | Rated voltage: 460 V |
| Head: _____ | Liquid temperature range: 32 .. 176 °F | Main frequency: 60 Hz |
| Efficiency: _____ | Product number: On request | |
| Liquid: Water | | |
| Temperature: 68 °F | | |
| NPSH required: _____ | | |
| Viscosity: _____ | | |
| Specific Gravity: 1.000 | | |

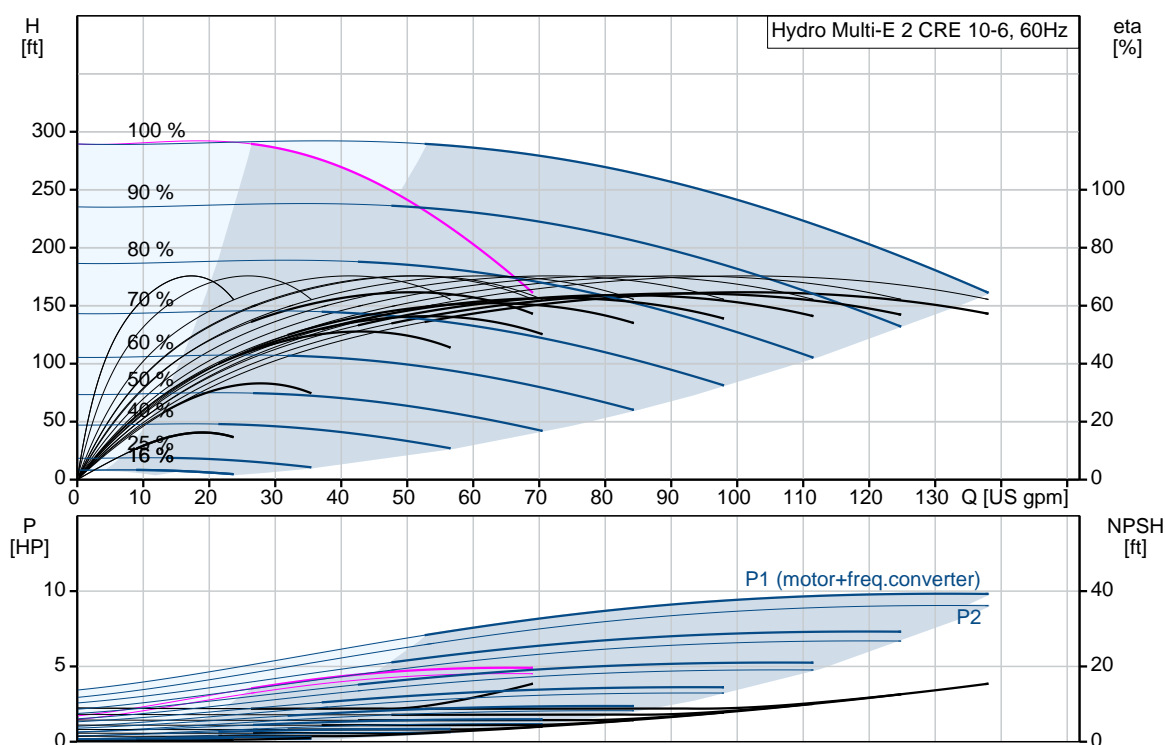

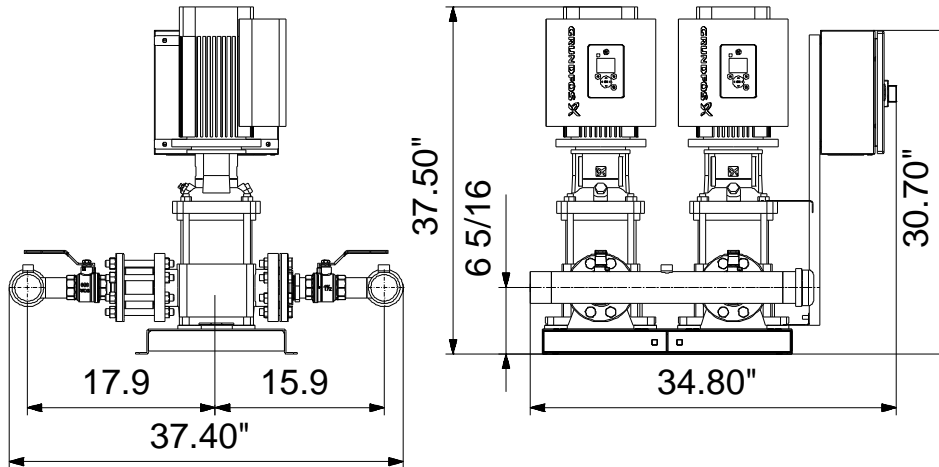

Materials:

Pump housing: Cast iron

Manifolds: Stainless steel

| Count | Description |
|-------|--|
| 1 | <p>Hydro Multi-E 2 CRE 10-6</p>  <p>Product photo could vary from the actual product</p> <p>Product No.: On request</p> <p>A GRUNDFOS Hydro Multi-E booster set consists of 2 to 4 speed controlled CR pumps (CRE pumps). Each CRE pump is equipped with an integrated variable frequency drive motor (MLE motor).</p> <ul style="list-style-type: none"> - Hydro Multi-E maintains constant pressure through continuous adjustment of the speed of the pumps. - The system performance is adapted to the demand through cutting in/out the required number of pumps and through parallel control of the pumps in operation. - Pump cascade control is based on first on first off to ensure equal pump wear. - All pumps in operation will run at equal speed. <p>GRUNDFOS Hydro Multi-E booster sets are designed for pressure boosting of clean water in residential/commercial building, municipal, industrial, and irrigation applications.</p> <p>The control of the Hydro Multi-E system is accomplished through Proportional-Integral control via a multi-pump controller card mounted in one of the MLE motors. The Hydro Multi-E system start/stop and set-point adjustment is possible through the use of two push buttons located on the MLE motor or with the R100 remote controller.</p> <p>The system consists of these parts:</p> <ul style="list-style-type: none"> - Suction manifold and discharge manifold made of 316 stainless steel. - Base frame made of 304 stainless steel. - One non-return valve (check valve), and two isolating valves for each pump. - Adapter with isolating valve for connection diaphragm tank. - Pressure gauge on suction and discharge manifolds. - Pressure transducer on discharge manifold. - Dry-running protection is standard with use of differential pressure switch on suction manifold. - A service disconnect switch located in a NEMA 3R enclosure is mounted to each pump for ease of service. - Grundfos bus communication with optional gateway connections for LON, Modbus, Profibus, BACnet, GSM <p>When delivered, the GRUNDFOS Hydro Multi-E booster set is factory tested and ready for operation.</p> <p>Diaphragm tank is available as an accessory.</p> <p>Liquid:</p> |



Company name: Hurley Engineering
Created by:
Phone:

Date: 3/24/2020

| Count | Description |
|-------|---|
| | <p>Pumped liquid: Water Liquid temperature range: 32 .. 176 °F Selected liquid temperature: 68 °F Density: 62.29 lb/ft³</p> <p>Materials: Pump housing: Cast iron</p> <p>Installation: Maximum operating pressure: 232.06 psi Maximum permissible inlet pressure: 145.04 psi Manifold inlet: 2.5" NPT Manifold outlet: 2.5" NPT</p> <p>Electrical data: Power (P2) main pump: 5 HP Main frequency: 60 Hz Rated voltage: 3 x 460 V Rated voltage main pump: 3 x 460 V Rated current: 12.2 A Start. method: electronically Radio interference supression: IEC/CISPR 11-1B</p> <p>Tank: Diaphragm tank: No</p> <p>Others: Net weight: 512 lb Gross weight: 735 lb Shipping volume: 89.7 ft³ Custom tariff no.: 8413.70.2040</p> |

On request Hydro Multi-E 2 CRE 10-6 60 Hz

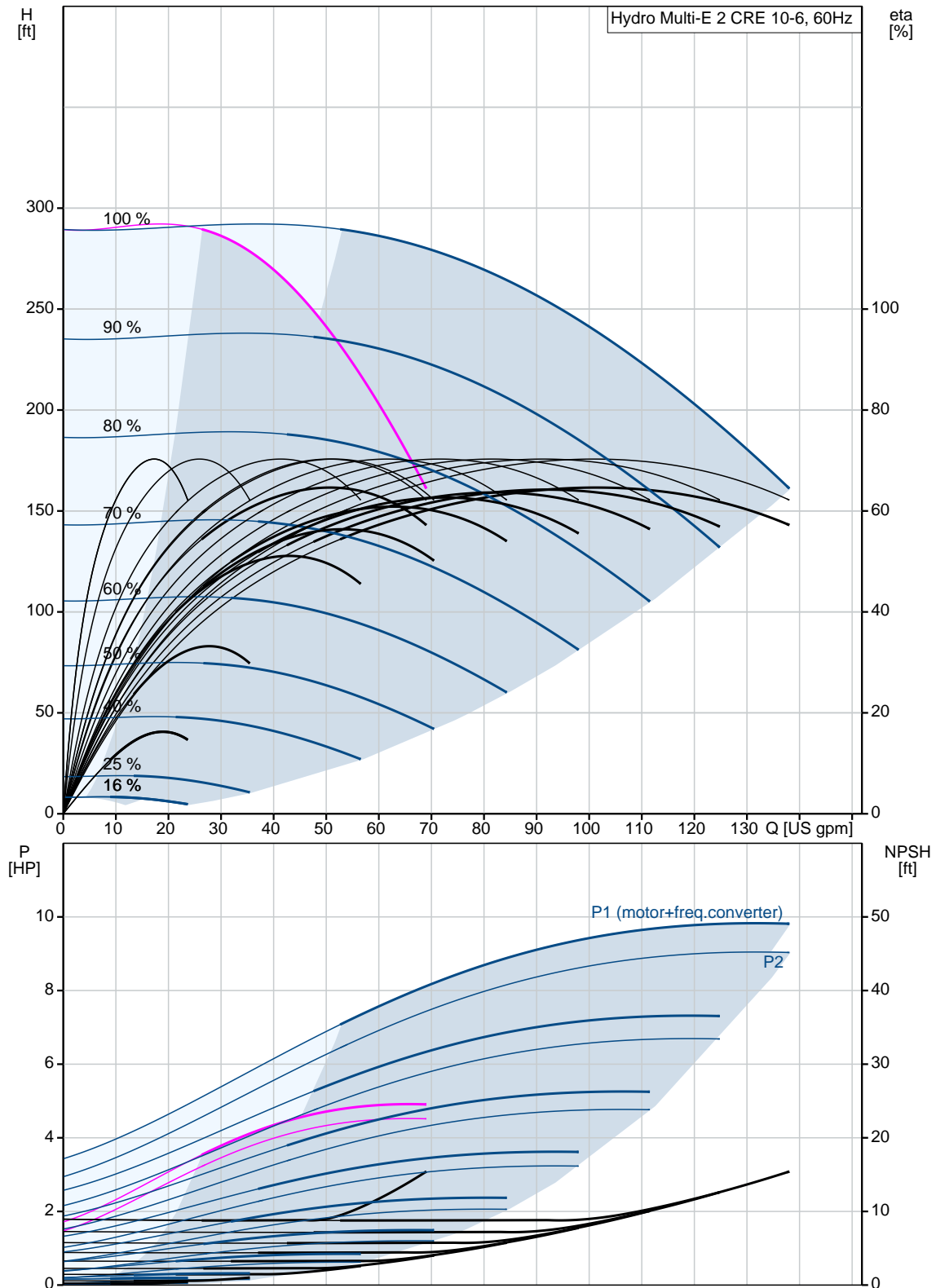

| Description | Value |
|-------------------------------------|--------------------------|
| General information: | |
| Product name: | Hydro Multi-E 2 CRE 10-6 |
| Product No.: | On request |
| EAN: | On request |
| | On request |
| Technical: | |
| Min flow system: | 0 US gpm |
| Max flow system: | 141 US gpm |
| Maximum head: | 289.1 ft |
| Pump name: | CRE10-6 |
| Number of pumps: | 2 |
| Materials: | |
| Pump housing: | Cast iron |
| Manifolds: | Stainless steel |
| Installation: | |
| Maximum operating pressure: | 232.06 psi |
| Maximum permissible inlet pressure: | 145.04 psi |
| Manifold inlet: | 2.5" NPT |
| Manifold outlet: | 2.5" NPT |
| Liquid: | |
| Pumped liquid: | Water |
| Liquid temperature range: | 32 .. 176 °F |
| Selected liquid temperature: | 68 °F |
| Density: | 62.29 lb/ft³ |
| Electrical data: | |
| Power (P2) main pump: | 5 HP |
| Main frequency: | 60 Hz |
| Rated voltage: | 3 x 460 V |
| Rated voltage main pump: | 3 x 460 V |
| Rated current: | 12.2 A |
| Start. method: | electronically |
| Radio interference supression: | IEC/CISPR 11-1B |
| Tank: | |
| Diaphragm tank: | No |
| Others: | |
| Net weight: | 512 lb |
| Gross weight: | 735 lb |
| Shipping volume: | 89.7 ft³ |
| Sales region: | Namreg |
| Product range: | NAMREG |
| Custom tariff no.: | 8413.70.2040 |

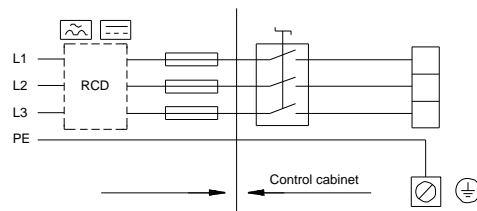
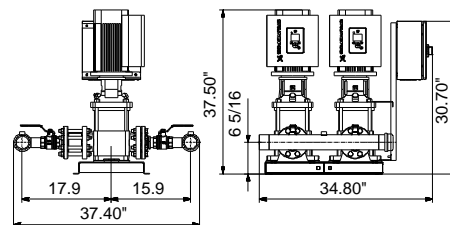
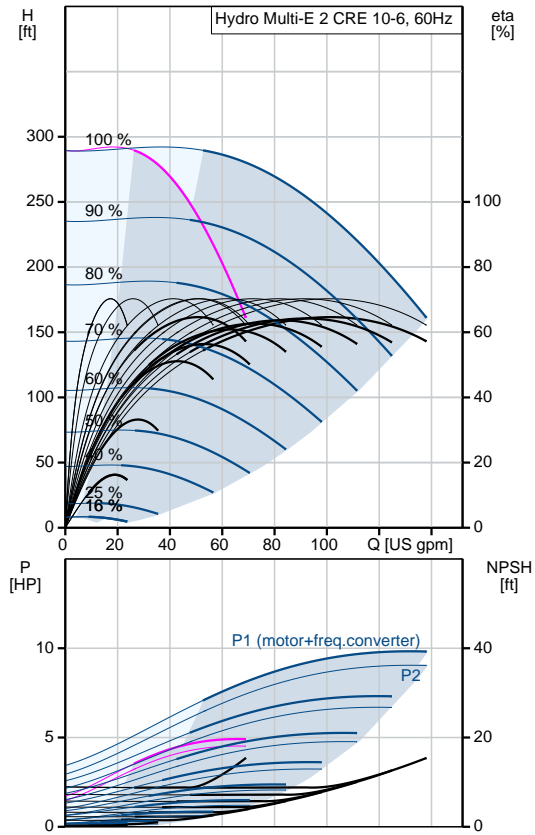

On request Hydro Multi-E 2 CRE 10-6 60 Hz

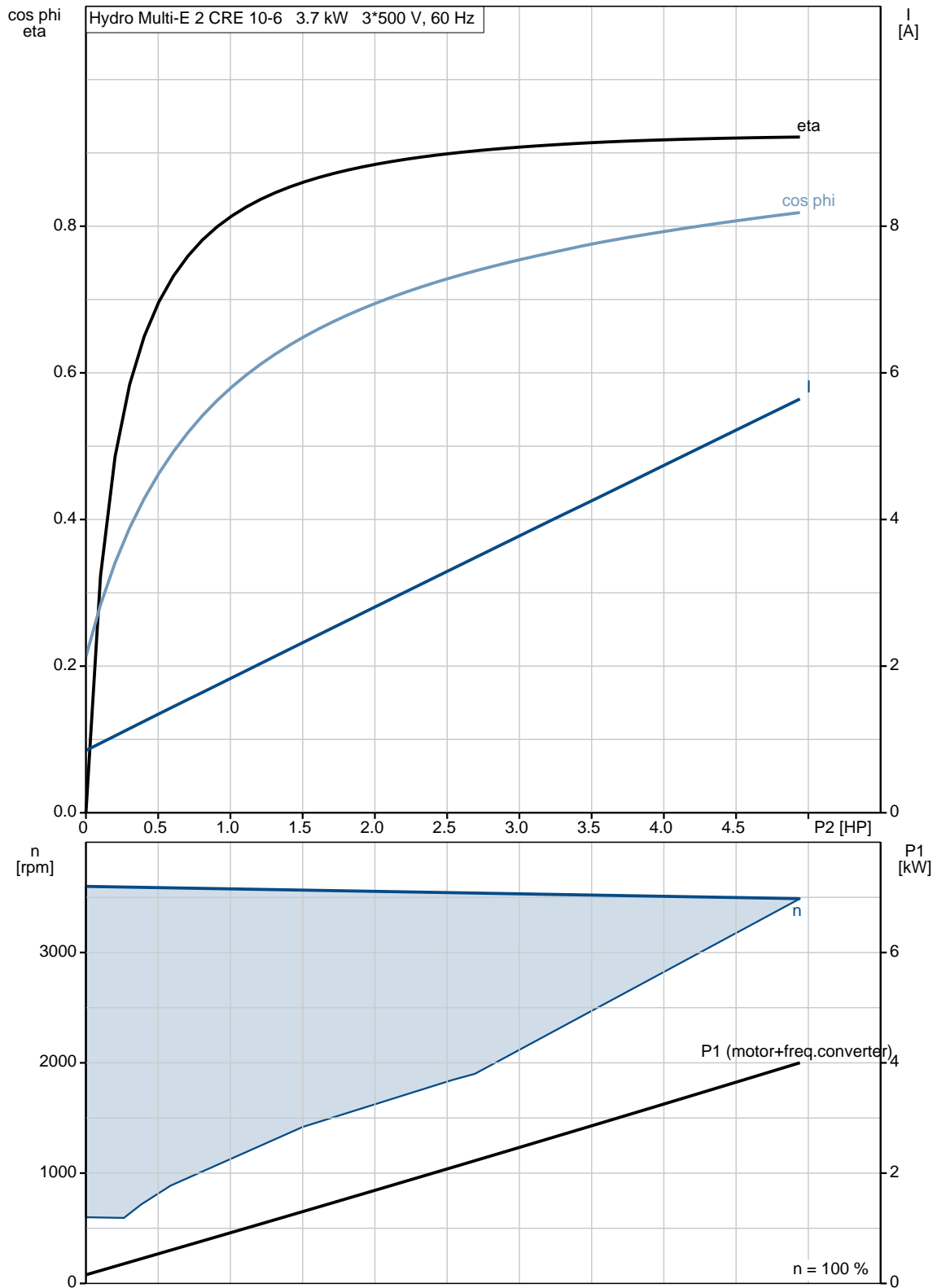

On request Hydro Multi-E 2 CRE 10-6 60 Hz

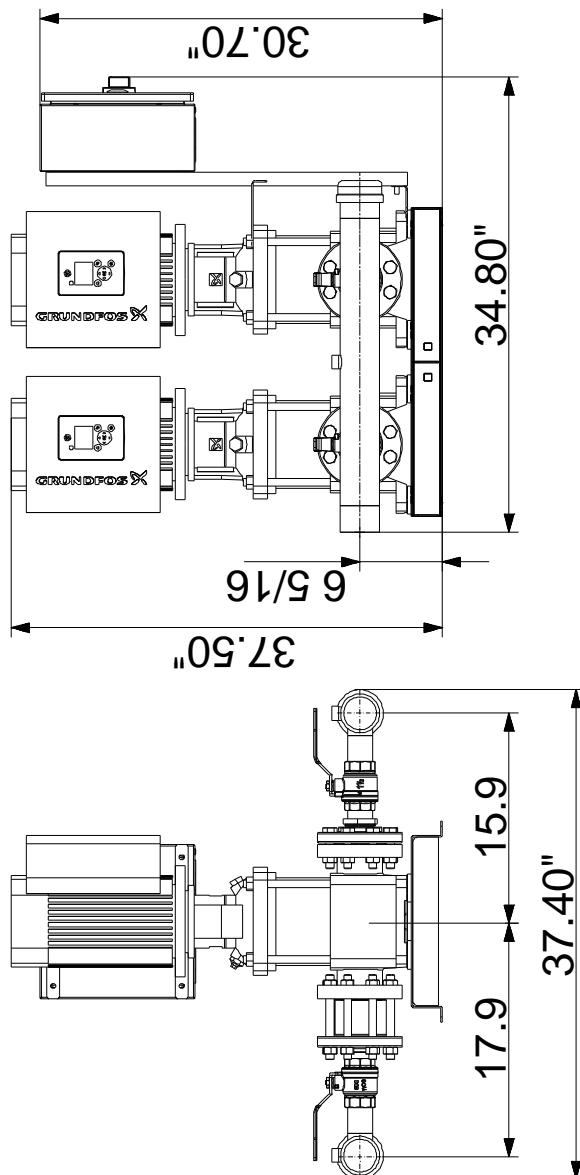

Note! All units are in [in] unless otherwise stated.
Disclaimer: This simplified dimensional drawing does not show all details.

On request Hydro Multi-E 2 CRE 10-6 60 Hz

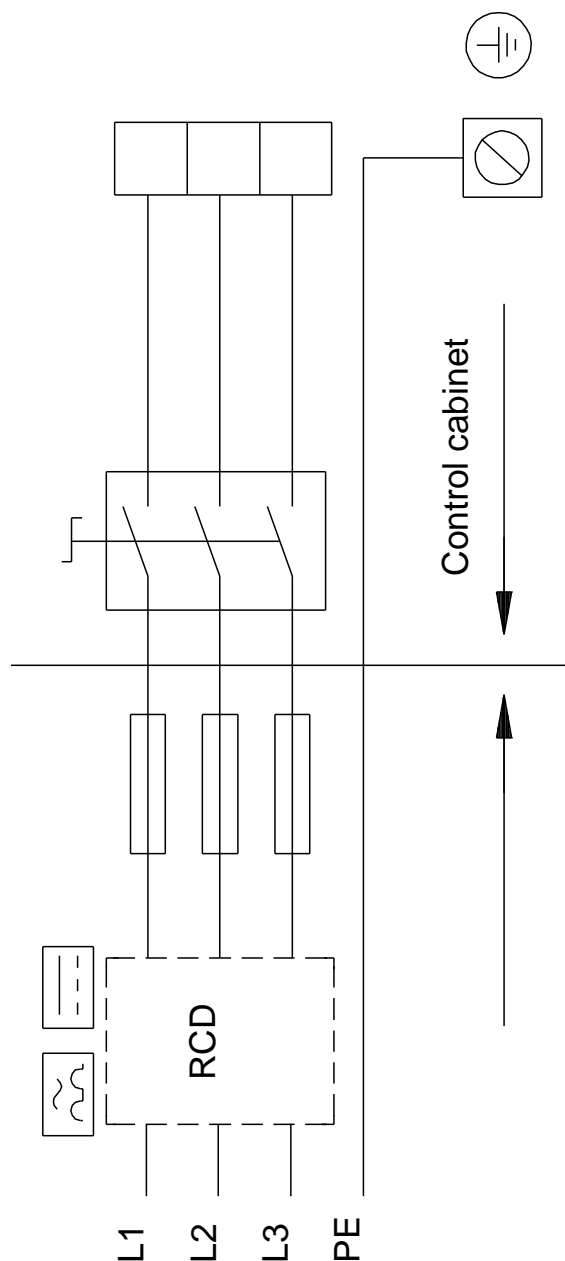

All units are [in] unless otherwise presented.